

**Cabinet Features**

Please specify type of handles required prior to order, i.e. wired pull or recessed pull  
 Locks to be ordered separately.  
 Master keying and grand master keying will incur additional costs.  
 Frameless glass doors cabinets; 1/4" Tempered Glass  
 Framed glass doors cabinets; 1/4" Float Glass  
 For 16" deep wall cabinets, please add "16" after the model number.  
 Example: WP201-3016

Open Face Cabinet – 30" High with 2 Shelves

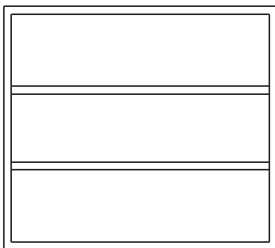

- W223-12    W223-30
- W223-15    W223-36
- W223-18    W223-42
- W223-24    W223-48

Solid Swing Door Cabinet - 30" High with 2 Shelves

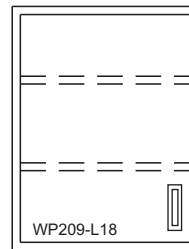

- W233-L12    W233-R12
- W233-L15    W233-R15
- W233-L18    W233-R18
- W233-L21    W233-R21
- W233-L24    W233-R24

\*L= Left Hinge    R= Right Hinge

Solid Swing Door Cabinet – 30" High with 2 Shelves

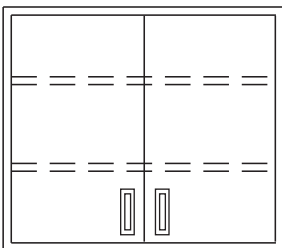

- W243-30
- W243-36
- W243-42
- W243-48

Solid Sliding Door Cabinet – 30" High with 2 Shelves

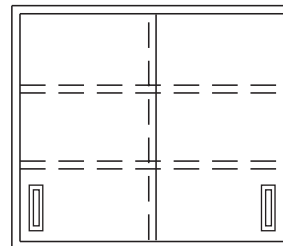

- W253-30
- W253-36
- W253-42
- W253-48

Glass Swing Door Cabinet – 30" High with 1 Shelf

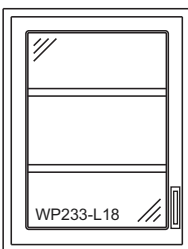

- W263-L12    W263-R12
- W263-L15    W263-R15
- W263-L18    W263-R18
- W263-L21    W263-R21
- W263-L24    W263-R24

\*L= Left Hinge    R= Right Hinge

Glass Sliding Door Cabinet – 30" High with 1 Shelf

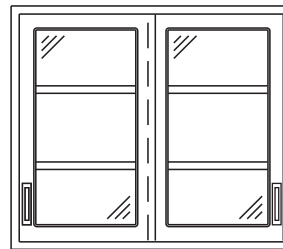

- W273-30
- W273-36
- W273-42
- W273-48

Framed Glass Swing Door Cabinet – 30" High with 2 Shelves

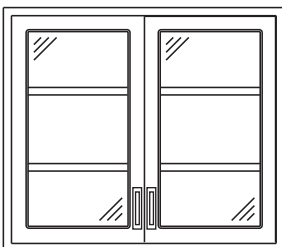

- W283-30
- W283-36
- W283-42
- W283-48

Frameless Glass Sliding Door Cabinet – 30" High with 2 Shelves

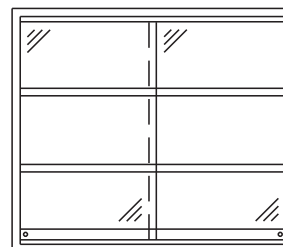

- W293-30
- W293-36
- W293-42
- W293-48