

Cabinet Features

Please specify type of handles required prior to order, i.e. wired pull or recessed pull
 Locks to be ordered separately.
 Master keying and grand master keying will incur additional costs.
 Frameless glass doors cabinets; 1/4" Tempered Glass
 Framed glass doors cabinets; 1/4" Float Glass
 For 16" deep wall cabinets, please add "16" after the model number.
 Example: WP201-3016

Open Face Cabinet – 36" High with 2 Shelves

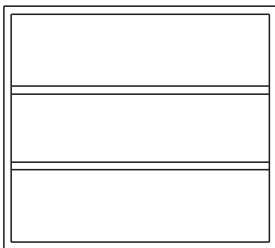

- W224-12 W224-30
- W224-15 W224-36
- W224-18 W224-42
- W224-24 W224-48

Solid Swing Door Cabinet - 36" High with 2 Shelves

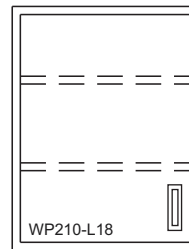

- W234-L12 W234-R12
- W234-L15 W234-R15
- W234-L18 W234-R18
- W234-L21 W234-R21
- W234-L24 W234-R24

*L= Left Hinge R= Right Hinge

Solid Swing Door Cabinet – 36" High with 2 Shelves

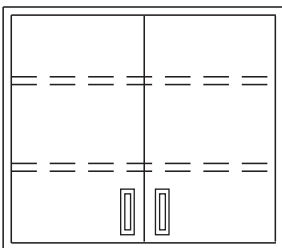

- W244-30
- W244-36
- W244-42
- W244-48

Solid Sliding Door Cabinet – 36" High with 2 Shelves

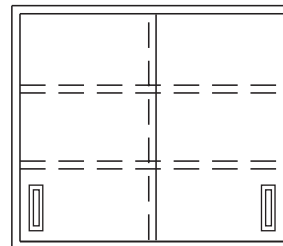

- W254-30
- W254-36
- W254-42
- W254-48

Glass Swing Door Cabinet – 36" High with 2 Shelves

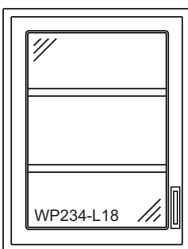

- W264-L12 W264-R12
- W26-L15 W264-R15
- W264-L18 W264-R18
- W264-L21 W264-R21
- W264-L24 W264-R24

*L= Left Hinge R= Right Hinge

Glass Sliding Door Cabinet – 36" High with 2 Shelves

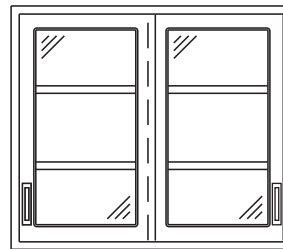

- W274-30
- W274-36
- W274-42
- W274-48

Framed Glass Swing Door Cabinet – 36" High with 2 Shelves

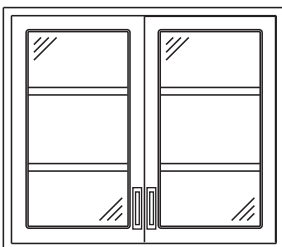

- W284-30
- W284-36
- W284-42
- W284-48

Frameless Glass Sliding Door Cabinet – 36" High with 2 Shelves

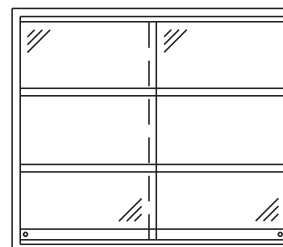

- W294-30
- W294-36
- W294-42
- W294-48