



Scientifically Advanced Interiors

BASE CABINETS

Painted Steel & Stainless Steel



LABORATORY CASEWORK

FUME HOODS

FLEXIBLE LAB FURNITURE

LABORATORY EQUIPMENT

SITTING HEIGHT CABINETS

28" HIGH

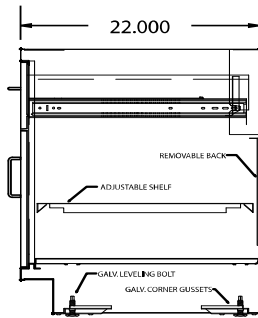

Cabinet Features

Adjustable shelf on all units except all drawer units.
 Work surfaces to be ordered separately.
 Please specify type of handles required prior to order, i.e. wired pull or recessed pull
 Locks to be ordered separately.
 Master keying and grand master keying will incur additional costs.

Note : Add "-S" at the end of model number for Stainless Steel Casework. Example B709-24-S

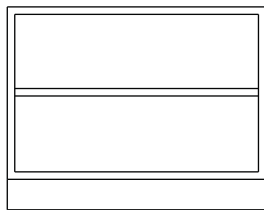

- B701-12 B701-30
- B701-15 B701-36
- B701-18 B701-42
- B701-24 B701-48

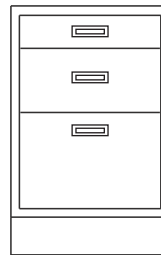

- B709-15
- B709-18
- B709-21
- B709-24

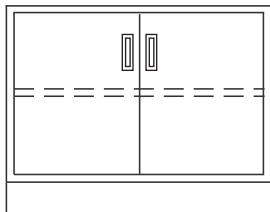

- B703-30
- B703-36
- B703-42
- B703-48



- B708-15
- B708-18
- B708-21
- B708-24

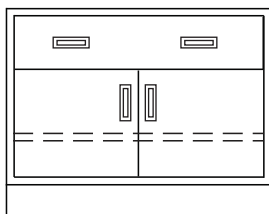

- B705-30
- B705-36
- B705-42
- B705-48

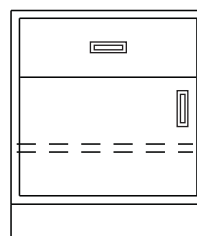

- B704-L15 B704-R15
- B704-L18 B704-R18
- B704-L21 B704-R21
- B704-L24 B704-R24

*L= Left Hinge R= Right Hinge

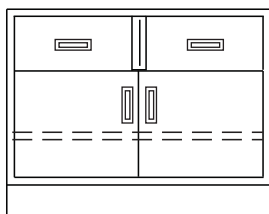

- B706-30
- B706-36
- B706-42
- B706-48

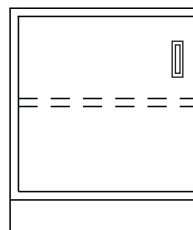

- B702-L15 B702-R15
- B702-L18 B702-R18
- B702-L21 B702-R21
- B702-L24 B702-R24

*L= Left Hinge R= Right Hinge

SITTING HEIGHT CABINETS

28" HIGH

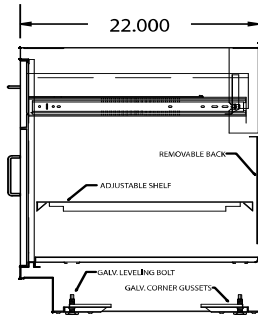

Cabinet Features

Adjustable shelf on all units except all drawer units.
 Work surfaces to be ordered separately.
 Please specify type of handles required prior to order,
 i.e. wired pull or recessed pull
 Locks to be ordered separately.
 Master keying and grand master keying will
 incur additional costs.

**Note : Add "-S" at the end of model number for
 Stainless Steel Casework. Example B709-24-S**



B711-30
 B711-36
 B711-42
 B711-48

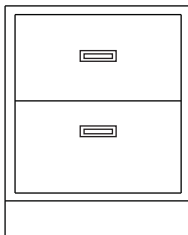

B707-15
 B707-18
 B707-21
 B707-24

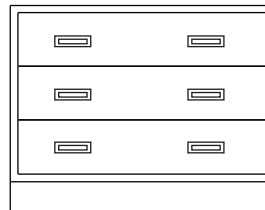

B710-30
 B710-36
 B710-42
 B710-48

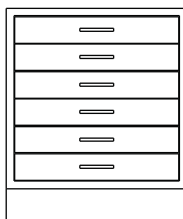

B725-15
 B725-18
 B725-21
 B725-24

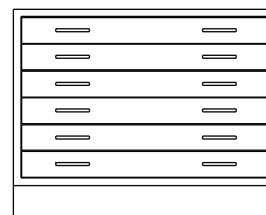

B726-30
 B726-36
 B726-42
 B726-48

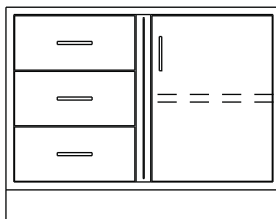

B727-L30 B727-R30
 B727-L36 B727-R36
 B727-L42 B727-R42
 B727-L48 B727-R48

*L= Left Hinge R= Right Hinge

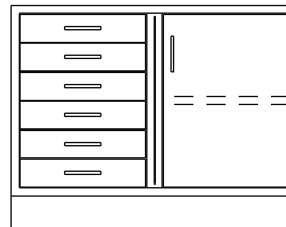

B728-L30 B728-R30
 B728-L36 B728-R36
 B728-L42 B728-R42
 B728-L48 B728-R48

*L= Left Hinge R= Right Hinge

SITTING HEIGHT - SINK CABINETS

28" HIGH

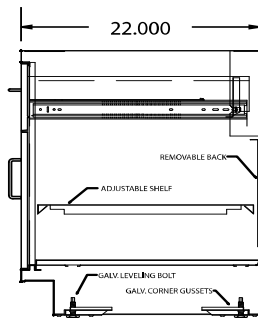

Cabinet Features

Adjustable shelf on all units except all drawer units.
 Work surfaces to be ordered separately.
 Please specify type of handles required prior to order,
 i.e. wired pull or recessed pull
 Locks to be ordered separately.
 Master keying and grand master keying will
 incur additional costs.

Note : Add "-S" at the end of model number for
 Stainless Steel Casework. Example B709-24-S

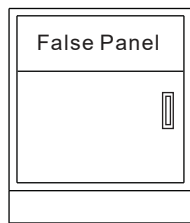

- B714-L12 B714-R12
- B714-L15 B714-R15
- B714-L18 B714-R18
- B714-L21 B714-R21
- B714-L24 B714-R24

*L= Left Hinge R= Right Hinge

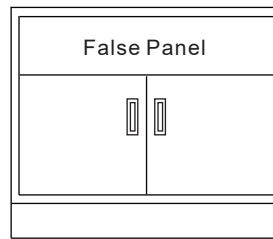

- B715-30
- B715-36
- B715-42
- B715-48

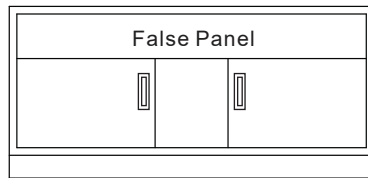

B716-60

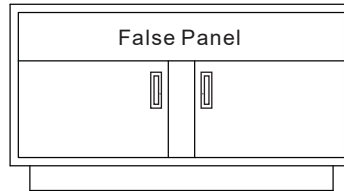

- B717-52
- B717-58

Island Sink Enclosure

SITTING HEIGHT - CORNER CABINETS

28" HIGH

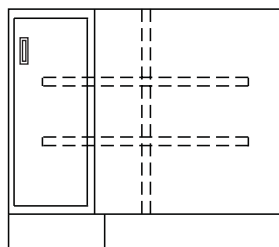
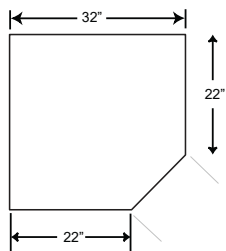

B712-R32

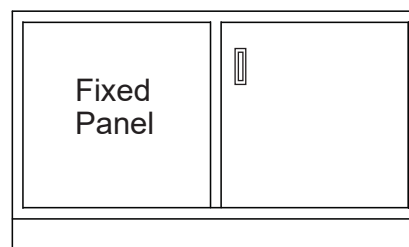

- B713-L36
- B713-R36
- B713-L42
- B713-R42
- B713-L48
- B713-R48

SITTING HEIGHT - SPECIALTY CABINETS

28" HIGH

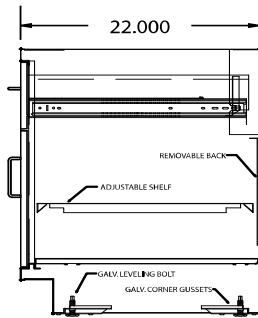

Cabinet Features

Adjustable shelf on all units except all drawer units.
 Work surfaces to be ordered separately.
 Please specify type of handles required prior to order, i.e. wired pull or recessed pull
 Locks to be ordered separately.
 Master keying and grand master keying may incur additional costs.

Note : Add "-S" at the end of model number for Stainless Steel Casework. Example B709-24-S

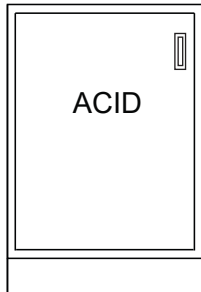

- B720-L12 B720-R12
- B720-L18 B720-R18
- B720-L24 B720-R24

*L= Left Hinge R= Right Hinge

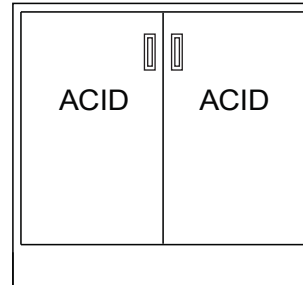

- B721-30
- B721-36
- B721-42
- B721-48

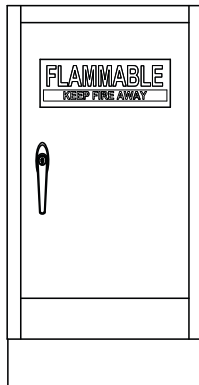

- B722-L18 B722-R18
- B722-L24 B722-R24

*L= Left Hinge R= Right Hinge

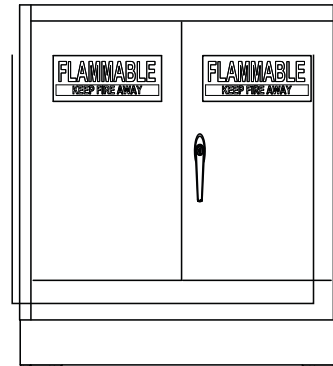

- B723-30
- B723-36
- B723-42
- B723-48

SITTING HEIGHT - FUME HOOD CABINETS

28" HIGH

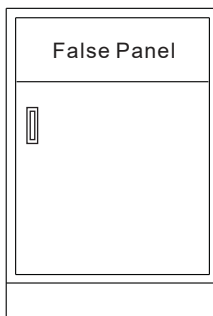

- B718-L12 B718-R12
- B718-L15 B718-R15
- B718-L18 B718-R18
- B718-L21 B718-R21
- B718-L24 B718-R24

*L= Left Hinge R= Right Hinge

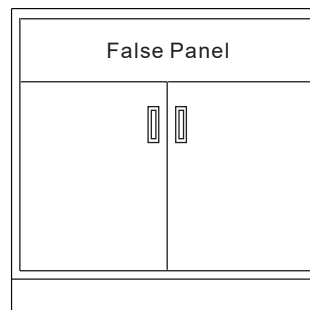

- B719-30
- B719-36
- B719-42
- B719-48

ADA HEIGHT CABINETS

32" HIGH

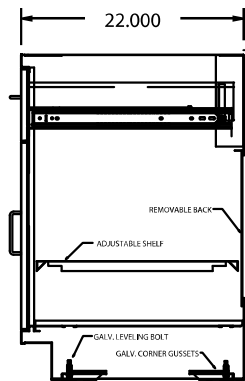

Cabinet Features

Adjustable shelf on all units except all drawer units.
 Work surfaces to be ordered separately.
 Please specify type of handles required prior to order, i.e. wired pull or recessed pull
 Locks to be ordered separately.
 Master keying and grand master keying will incur additional costs.

Note : Add "-S" at the end of model number for **Stainless Steel Casework. Example B801-48-S**

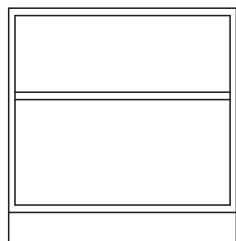

- | | |
|---------|---------|
| B801-12 | B801-30 |
| B801-15 | B801-36 |
| B801-18 | B801-42 |
| B801-24 | B801-48 |

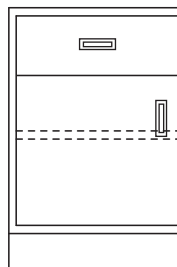

- | | |
|----------|----------|
| B804-L15 | B804-R15 |
| B804-L18 | B804-R18 |
| B804-L21 | B804-R21 |
| B804-L24 | B804-R24 |

*L= Left Hinge R= Right Hinge

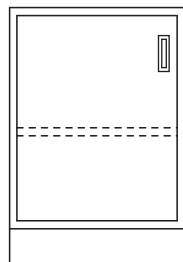

- | | |
|----------|----------|
| B802-L12 | B802-R12 |
| B802-L15 | B802-R15 |
| B802-L18 | B802-R18 |
| B802-L21 | B802-R21 |
| B802-L24 | B802-R24 |

*L= Left Hinge R= Right Hinge

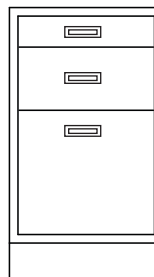

- | |
|---------|
| B808-15 |
| B808-18 |
| B808-21 |
| B808-24 |

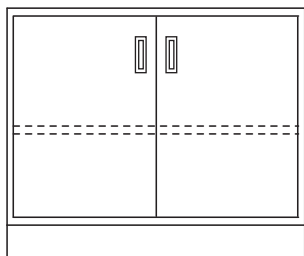

- | |
|---------|
| B803-30 |
| B803-36 |
| B803-42 |
| B803-48 |

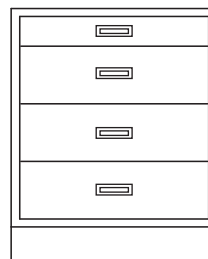

- | |
|---------|
| B809-15 |
| B809-18 |
| B809-21 |
| B809-24 |

ADA HEIGHT CABINETS

32" HIGH

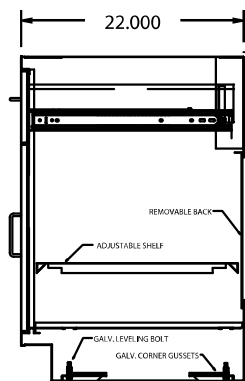

Cabinet Features

Adjustable shelf on all units except all drawer units.

Work surfaces to be ordered separately.

Please specify type of handles required prior to order, i.e. wired pull or recessed pull

Locks to be ordered separately.

Master keying and grand master keying will incur additional costs.

Note : Add "-S" at the end of model number for Stainless Steel Casework. Example B801-48-S

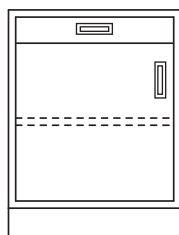

- B805-L15 B805-R15
- B805-L18 B805-R18
- B805-L21 B805-R21
- B805-L24 B805-R24

*L= Left Hinge R= Right Hinge

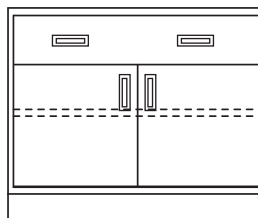

- B806-30
- B806-36
- B806-42
- B806-48

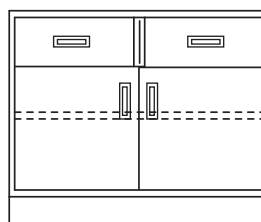

- B807-30
- B807-36
- B807-42
- B807-48

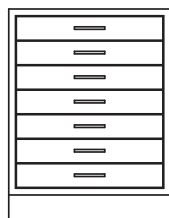

- B823-15
- B823-18
- B823-21
- B823-24

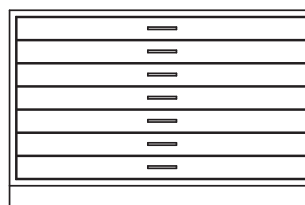

- B824-30
- B824-36
- B824-42
- B824-48

ADA HEIGHT - CORNER CABINETS

32" HIGH

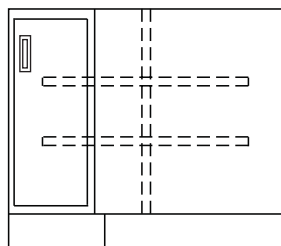
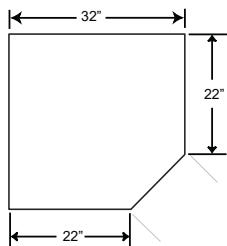

B810-32

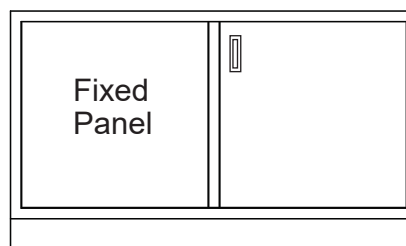

- B811-L36
- B811-R36
- B811-L42
- B811-R42
- B811-L48
- B811-R48

*L= Left Hinge R= Right Hinge

ADA HEIGHT - SINK CABINETS

32" HIGH

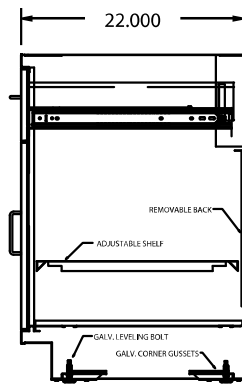

Cabinet Features

Adjustable shelf on all units except all drawer units.
 Work surfaces to be ordered separately.
 Please specify type of handles required prior to order,
 i.e. wired pull or recessed pull
 Locks to be ordered separately.
 Master keying and grand master keying will
 incur additional costs.

**Note : Add "-S" at the end of model number for
 Stainless Steel Casework. Example B801-48-S**

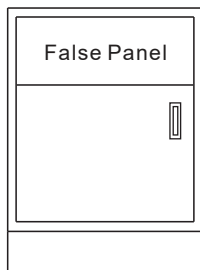

- | | |
|----------|----------|
| B812-L12 | B812-R12 |
| B812-L15 | B812-R15 |
| B812-L18 | B812-R18 |
| B812-L21 | B812-R21 |
| B812-L24 | B812-R24 |

*L= Left Hinge R= Right Hinge



- | | |
|---------|---------|
| B816-36 | B816-58 |
| B816-42 | B816-60 |
| B816-48 | B816-66 |
| B816-54 | B816-72 |

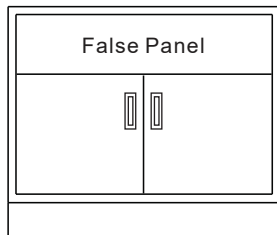

- B813-30
 B813-36
 B813-42
 B813-48

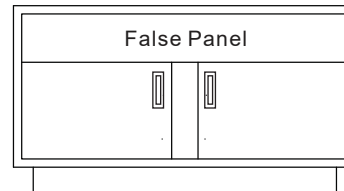

- B815-52
 B815-58

Island Sink Enclosure

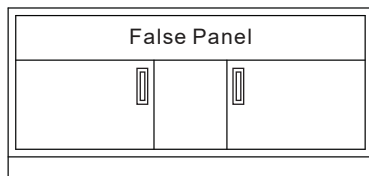

- B814-60

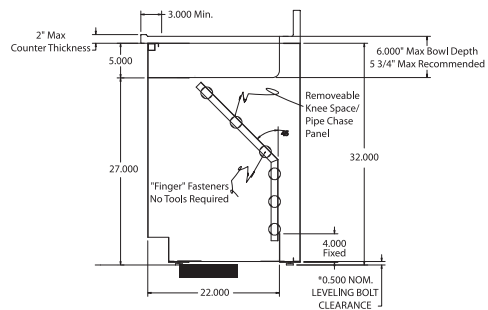

ADA HEIGHT - SPECIALTY CABINETS

32" HIGH

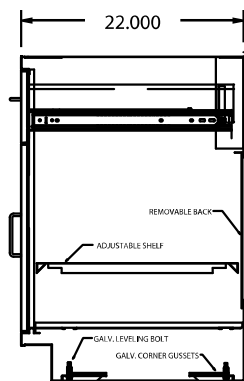

Cabinet Features

Adjustable shelf on all units except all drawer units.

Work surfaces to be ordered separately.

Please specify type of handles required prior to order, i.e. wired pull or recessed pull

Locks to be ordered separately.

Master keying and grand master keying may incur additional costs.

Note : Add "-S" at the end of model number for Stainless Steel Casework. Example B801-48-S



- B817-L12 B817-R12
- B817-L18 B817-R18
- B817-L24 B817-R24

*L= Left Hinge R= Right Hinge

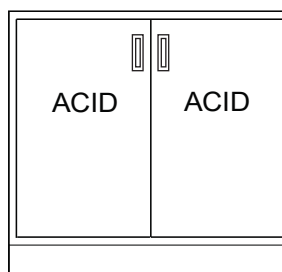

- B818-30
- B818-36
- B818-42
- B818-48

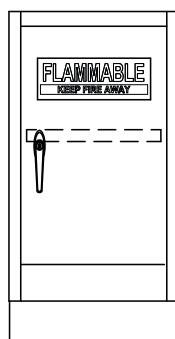

- B819-L18 B819-R18
- B819-L24 B819-R24

*L= Left Hinge R= Right Hinge

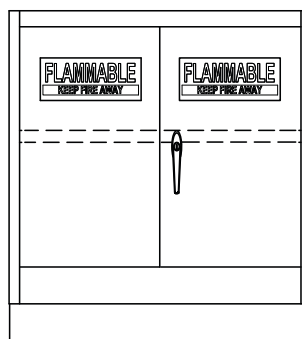

- B820-30
- B820-36
- B820-42
- B820-48

ADA HEIGHT - FUME HOOD CABINETS

32" HIGH

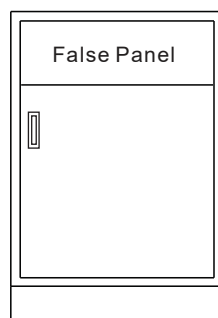

- B821-L12 B821-R12
- B821-L15 B821-R15
- B821-L18 B821-R18
- B821-L21 B821-R21
- B821-L24 B821-R24

*L= Left Hinge R= Right Hinge

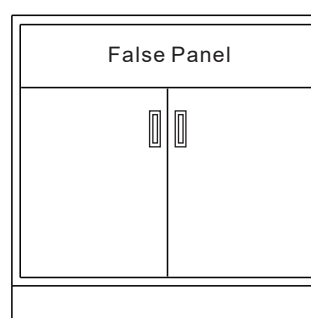

- B822-30
- B822-36
- B822-42
- B822-48

STANDING HEIGHT CABINETS

35" HIGH

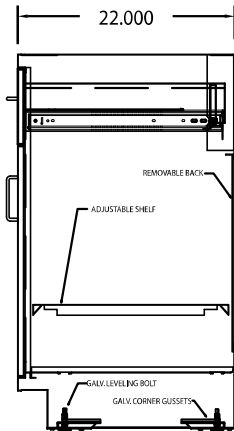

Cabinet Features

Adjustable shelf on all units except all drawer units.
 Work surfaces to be ordered separately.
 Please specify type of handles required prior to order,
 i.e. wired pull or recessed pull
 Locks to be ordered separately.
 Master keying and grand master keying will
 incur additional costs.

Note : Add "-S" at the end of model number for
 Stainless Steel Casework. Example B903-48-S

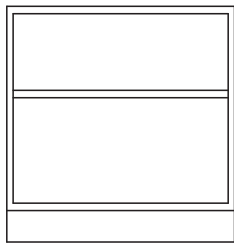

- B901-12 B901-30
- B901-15 B901-36
- B901-18 B901-42
- B901-24 B901-48

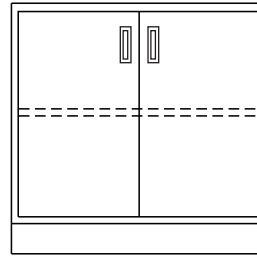

- B903-30
- B903-36
- B903-42
- B903-48

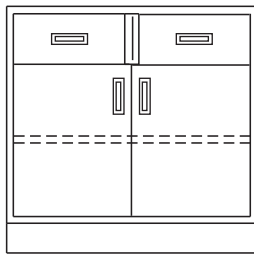

- B906-30
- B906-36
- B906-42
- B906-48

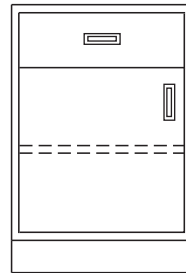

- B904-L15 B904-R15
- B904-L18 B904-R18
- B904-L21 B904-R21
- B904-L24 B904-R24

*L= Left Hinge R= Right Hinge

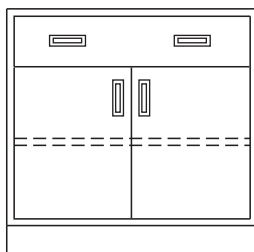

- B905-30
- B905-36
- B905-42
- B905-48

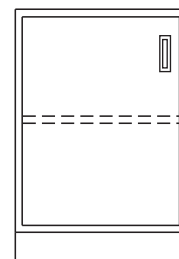

- B902-L15 B902-R15
- B902-L18 B902-R18
- B902-L21 B902-R21
- B902-L24 B902-R24

*L= Left Hinge R= Right Hinge

STANDING HEIGHT CABINETS

35" HIGH

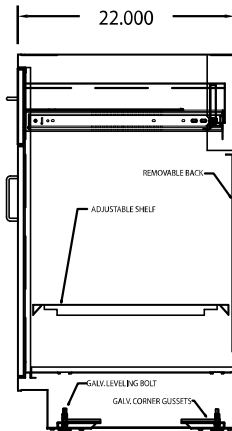

Cabinet Features

Adjustable shelf on all units except all drawer units.
 Work surfaces to be ordered separately.
 Please specify type of handles required prior to order,
 i.e. wired pull or recessed pull
 Locks to be ordered separately.
 Master keying and grand master keying will
 incur additional costs.

**Note : Add "-S" at the end of model number for
 Stainless Steel Casework. Example B903-48-S**

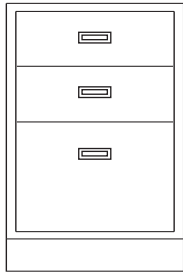

- B908-15
- B908-18
- B908-21
- B908-24

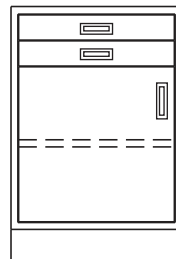

- B907-L15 B907-R15
- B907-L18 B907-R18
- B907-L21 B907-R21
- B907-L24 B907-R24

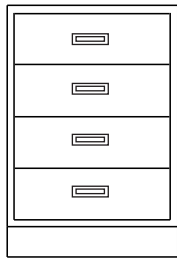

- B909-15
- B909-18
- B909-21
- B909-24

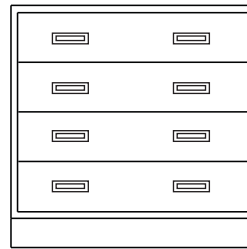

- B910-30
- B910-36
- B910-42
- B910-48

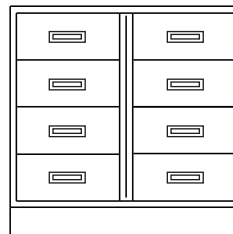

- B913-30
- B913-36
- B913-42
- B913-48

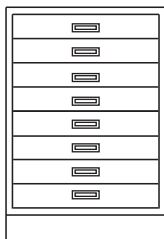

- B911-15
- B911-18
- B911-21
- B911-24

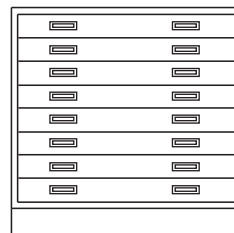

- B912-30
- B912-36
- B912-42
- B912-48

STANDING HEIGHT CABINETS

35" HIGH

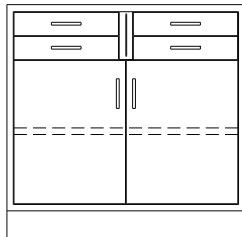

B929-30
B929-36
B929-42
B929-48

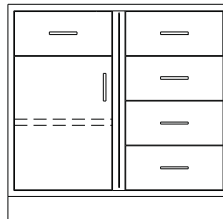

B931-L30 B931-R30
B931-L36 B931-R36
B931-L42 B931-R42
B931-L48 B931-R48
*L= Left Hinge R= Right Hinge

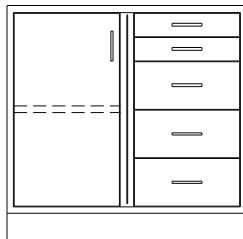

B932-L30 B932-R30
B932-L36 B932-R36
B932-L42 B932-R42
B932-L48 B932-R48
*L= Left Hinge R= Right Hinge

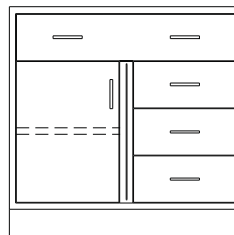

B930-L30 B930-R30
B930-L36 B930-R36
B930-L42 B930-R42
B930-L48 B930-R48
*L= Left Hinge R= Right Hinge

STANDING HEIGHT - CORNER CABINETS

35" HIGH

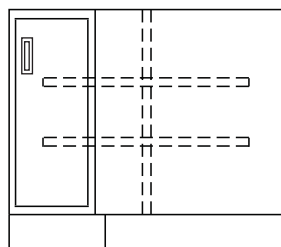
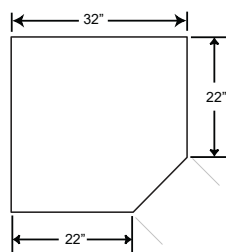

B918-L32
B918-R32

*L= Left Hinge R= Right Hinge

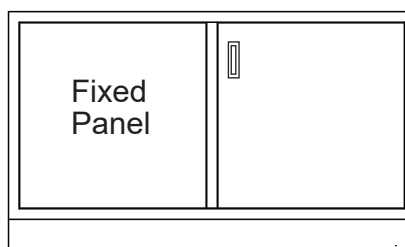

B919-L36
B919-R36
B919-L42
B919-R42
B919-L48
B919-R48

*L= Left Hinge R= Right Hinge

STANDING HEIGHT - SINK CABINETS

35" HIGH

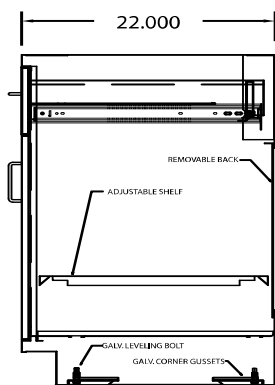

Cabinet Features

Adjustable shelf on all units except all drawer units.
 Work surfaces to be ordered separately.
 Please specify type of handles required prior to order, i.e. wired pull or recessed pull
 Locks to be ordered separately.
 Master keying and grand master keying will incur additional costs.

Note : Add "-S" at the end of model number for Stainless Steel Casework. Example B903-48-S

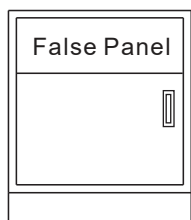

- | | |
|----------|----------|
| B914-L12 | B914-R12 |
| B914-L15 | B914-R15 |
| B914-L18 | B914-R18 |
| B914-L21 | B914-R21 |
| B914-L24 | B914-R24 |

*L= Left Hinge R= Right Hinge

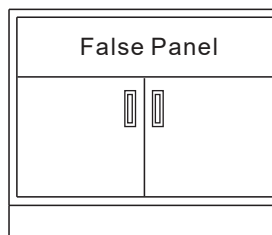

- B915-30
 B915-36
 B915-42
 B915-48

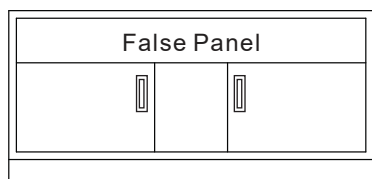

B916-60

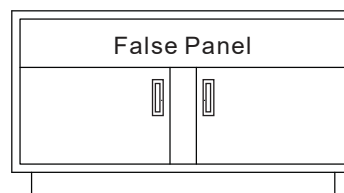

Island Sink Enclosure

- B917-52
 B917-58
 B917-60

STANDING HEIGHT - FUME HOOD CABINETS

35" HIGH

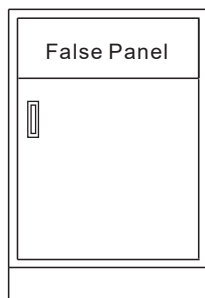

- | | |
|----------|----------|
| B924-L12 | B924-R12 |
| B924-L15 | B924-R15 |
| B924-L18 | B924-R18 |
| B924-L21 | B924-R21 |
| B924-L24 | B924-R24 |

*L= Left Hinge R= Right Hinge

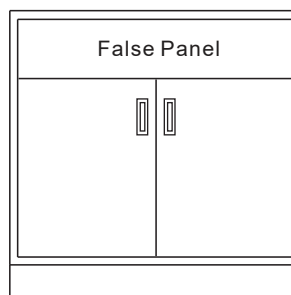

- B925-30
 B925-36
 B925-42
 B925-48

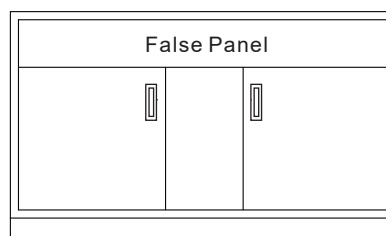

B926-60

STANDING HEIGHT - SPECIALTY CABINETS

35" HIGH

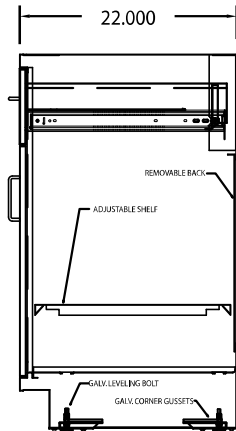

Cabinet Features

Adjustable shelf on all units except all drawer units.
 Work surfaces to be ordered separately.
 Please specify type of handles required prior to order,
 i.e. wired pull or recessed pull
 Locks to be ordered separately.
 Master keying and grand master keying will
 incur additional costs.

Note : Add "-S" at the end of model number for
 Stainless Steel Casework. Example B903-48-S



- B920-L12 B920-R12
- B920-L18 B920-R18
- B920-L24 B920-R24

*L= Left Hinge R= Right Hinge

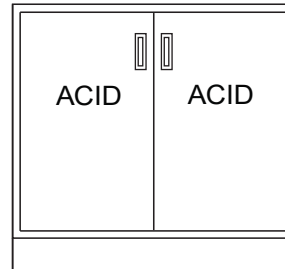

- B921-30
- B921-36
- B921-42
- B921-48

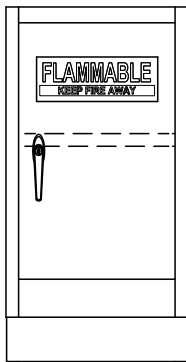

- B927-L18 B927-R18
- B927-L24 B927-R24

*L= Left Hinge R= Right Hinge

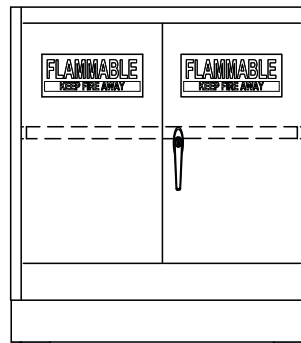

- B923-30
- B923-36
- B923-42
- B923-48

MOBILE BASE CABINETS

22" HIGH

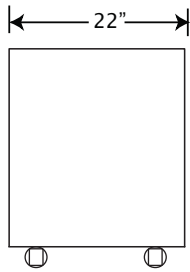

Cabinet Features

Adjustable shelf on all units except all drawer units.

Work surfaces to be ordered separately.

Please specify type of handles required prior to order, i.e. wired pull or recessed pull

Locks to be ordered separately. Master keying and grand master keying will incur additional costs.

Drawer stack cabinets equipped with interlocking mechanism to allow one drawer open at a time.

Mobile cabinets include a counter weight system to prevent forward tipping when drawer or doors are open.

Note : Add "-S" at the end of model number for **Stainless Steel Casework.** Example **B502-36-S**

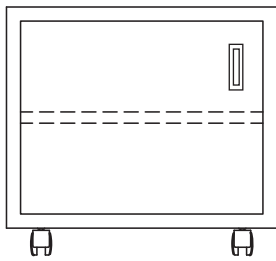

B501-L18 B501-R18
B501-L24 B501-R24

*L= Left Hinge R= Right Hinge

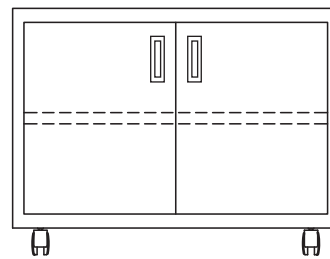

B502-30
B502-36

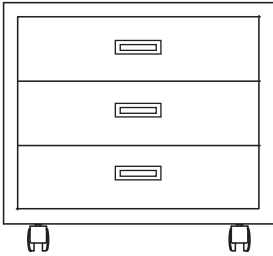

B505-18
B505-24
B505-30
B505-36

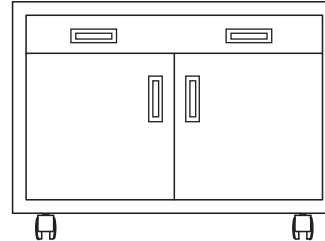

B504-30

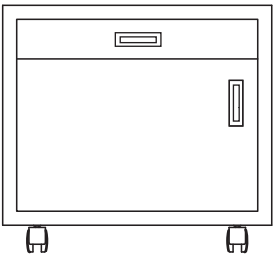

B503-L24
B503-R24

*L= Left Hinge R= Right Hinge

MOBILE BASE CABINETS

28" HIGH

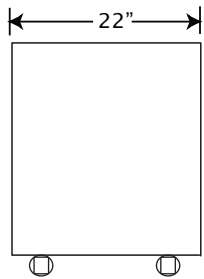

Cabinet Features

Adjustable shelf on all units except all drawer units.

Work surfaces to be ordered separately.

Please specify type of handles required prior to order, i.e. wired pull or recessed pull

Locks to be ordered separately. Master keying and grand master keying will incur additional costs.

Drawer stack cabinets equipped with interlocking mechanism to allow one drawer open at a time.

Mobile cabinets include a counter weight system to prevent forward tipping when drawer or doors are open.

Note : Add "-S" at the end of model number for Stainless Steel Casework. Example B903-48-S

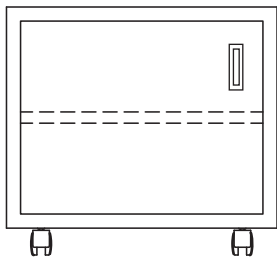

B601-L18 B601-R18
B601-L24 B601-R24

*L= Left Hinge R= Right Hinge

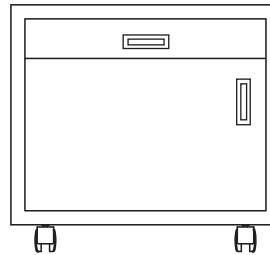

B602-L24
B602-R24

*L= Left Hinge R= Right Hinge

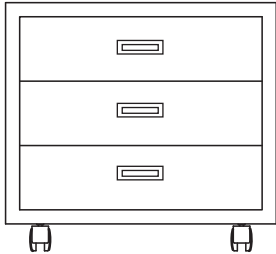

B606-18
B606-24
B606-30
B606-36

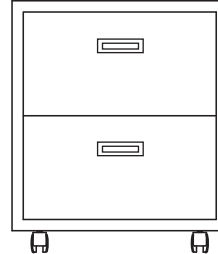

B604-18
B604-24

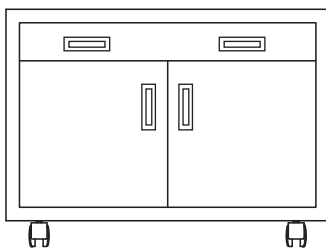

B605-30
B605-36

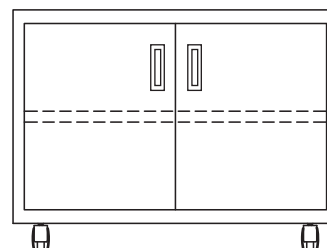

B603-30
B603-36

MOBILE BASE CABINETS

32" HIGH

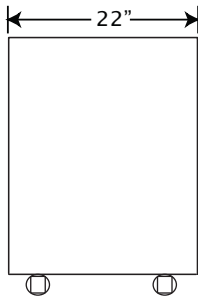

Cabinet Features

Adjustable shelf on all units except all drawer units.

Work surfaces to be ordered separately.

Please specify type of handles required prior to order, i.e. wired pull or recessed pull

Locks to be ordered separately. Master keying and grand master keying will incur additional costs.

Drawer stack cabinets equipped with interlocking mechanism to allow one drawer open at a time.

Mobile cabinets include a counter weight system to prevent forward tipping when drawer or doors are open.

Note : Add "-S" at the end of model number for Stainless Steel Casework. Example B903-48-S

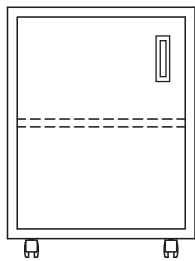

B701-L18 B701-R18
B701-L24 B701-R24

*L= Left Hinge R= Right Hinge

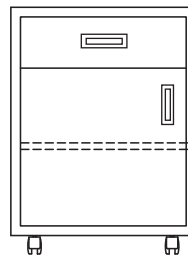

B703-L18 B703-R18
B703-L24 B703-R24

*L= Left Hinge R= Right Hinge

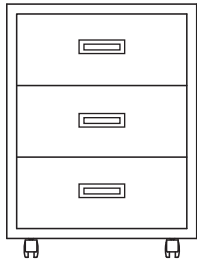

B705-18
B705-24
B705-30
B705-36

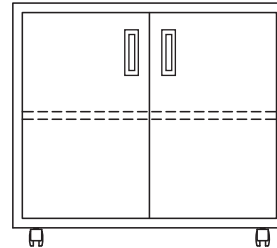

B702-30
B702-36
B702-42
B702-48

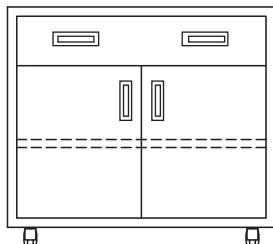

B704-30
B704-36
B704-42

SUSPENDED CABINETS

24 1/2" HIGH X 22" DEEP

Review the beginning of this section to properly indicate your cabinet selections.

Cabinets come standard with wire pull.

Please note: You must specify lock keying preferences when ordering locks; master keying and grand master keying may incur additional costs.

Note : Add "-S" at the end of model number for Stainless Steel Casework. Example F817-48-S

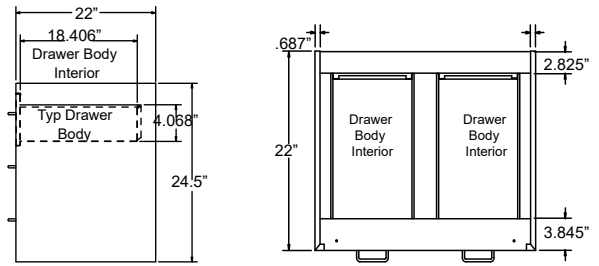

Drawer & Door Heights			
Drawer Letter	Approx. Height	Door Letter	Approx. Height
A	3-1/2"	E	14-1/2"
B	7"	G	22"
C	10-1/2"	H	29"
D	14-1/2"		

Hanging Cabinet Detail

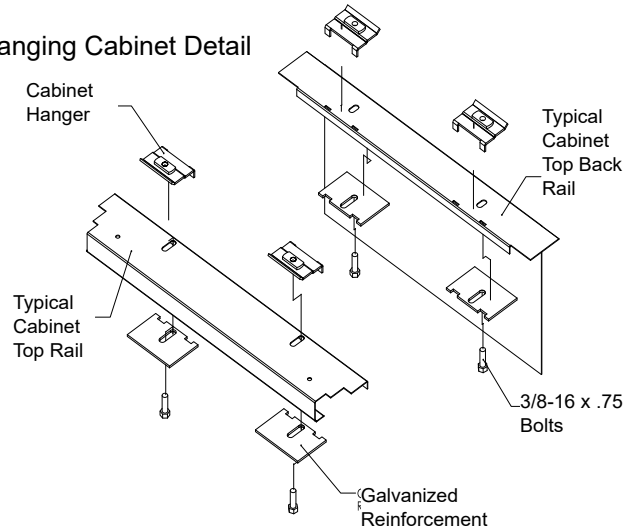

F817-30
F817-36
F817-42
F817-48



F818-15
F818-18
F818-21
F818-24

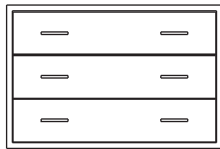

F819-30
F819-36
F819-42
F819-48

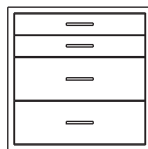

F820-15
F820-18
F820-21
F820-24

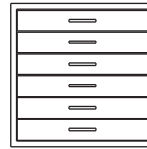

F821-15
F821-18
F821-21
F821-24



F822-15
F822-18
F822-21



F823-30
F823-36
F823-42
F823-48



F824-30
F824-36
F824-42
F824-48



F825-30
F825-36
F825-42
F825-48

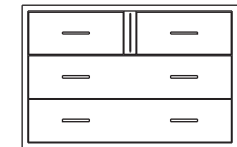

F826-30
F826-36
F826-42
F826-48



F827-30
F827-36
F827-42
F827-48

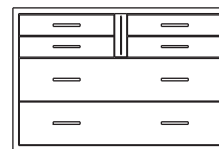

F828-30
F828-36
F828-42
F828-48



F815-30
F815-36
F815-42
F815-48



F816-30
F816-36
F816-42
F816-48

SUSPENDED CABINETS

24 1/2" HIGH X 22" DEEP

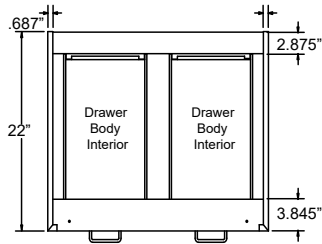
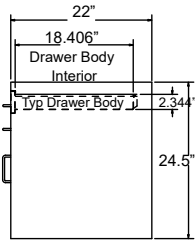

Review the beginning of this section to properly indicate your cabinet selections.

Cabinets come standard with wire pull.

Please note: You must specify lock keying preferences when ordering locks; master keying and grand master keying may incur additional costs.

Note : Add "-S" at the end of model number for **Stainless Steel Casework**. Example F833-48-S

Drawer & Door Heights			
Drawer Letter	Approx. Height	Door Letter	Approx. Height
A	3-1/2"	E	14-1/2"
B	7"	G	22"
C	10-1/2"	H	29"
D	14-1/2"		

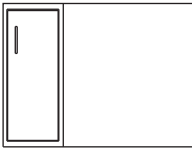

F829-32

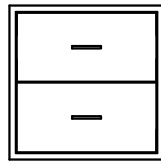

F833-15
F833-18
F833-21
F833-24

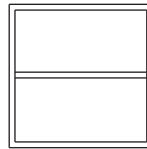

F801-12 F801-30
F801-15 F801-36
F801-18 F801-42
F801-21 F801-48
F801-24

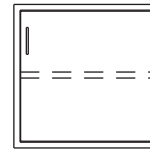

F802-12
F802-15
F802-18
F802-21
F802-24

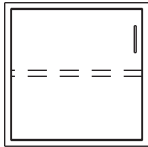

F803-12
F803-15
F803-18
F803-21
F803-24

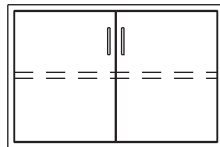

F804-30
F804-36
F804-42
F804-48

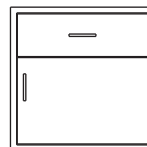

F805-15
F805-18
F805-21
F805-24

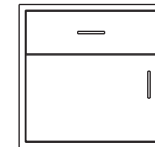

F806-15
F806-18
F806-21
F806-24

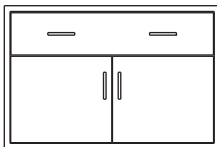

F807-30
F807-36
F807-42
F807-48

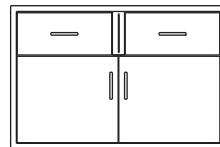

F808-30
F808-36
F808-42
F808-48



F809-30
F809-36
F809-42
F809-48

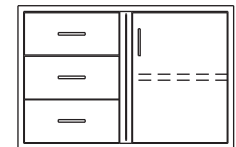

F810-30
F810-36
F810-42
F810-48

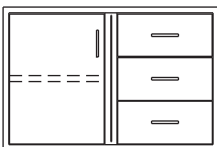

F811-30
F811-36
F811-42
F811-48



F812-30
F812-36
F812-42
F812-48

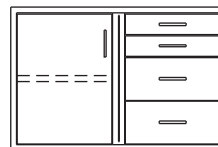

F813-30
F813-36
F813-42
F813-48



F814-30
F814-36
F814-42
F814-48

SUSPENDED CABINETS

31 3/4" HIGH x 22" DEEP

Review the beginning of this section to properly indicate your cabinet selections.

Cabinets come standard with wire pull.

Please note: You must specify lock keying preferences when ordering locks; master keying and grand master keying may incur additional costs.

Note : Add "-S" at the end of model number for Stainless Steel Casework. Example F841-24-S

Drawer & Door Heights			
Drawer Letter	Approx. Height	Door Letter	Approx. Height
A	3-1/2"	E	14-1/2"
B	7"	G	22"
C	10-1/2"	H	29"
D	14-1/2"		

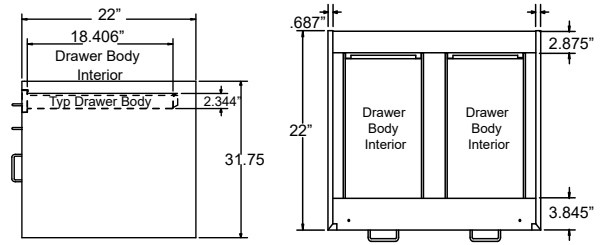

Hanging Cabinet Detail

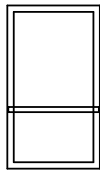
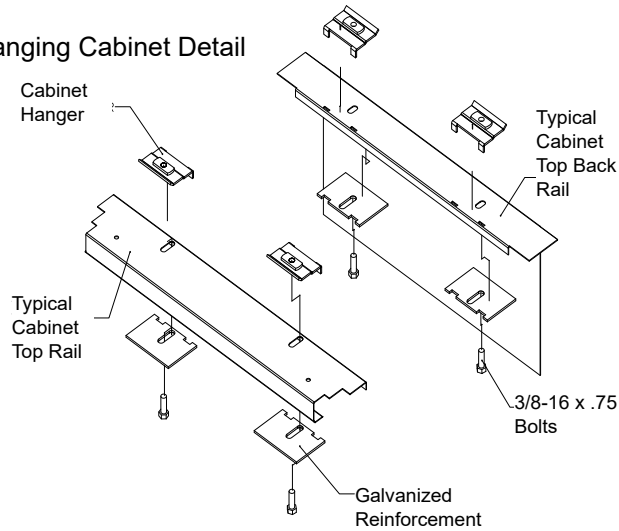

F840-12 F840-30
F840-15 F840-36
F840-18 F840-42
F840-21 F840-48
F840-24

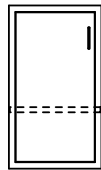

F841-12
F841-15
F841-18
F841-21
F841-24

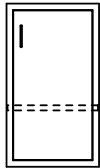

F842-12
F842-15
F842-18
F842-21
F842-24

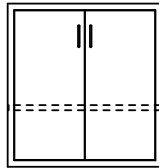

F843-30
F843-36
F843-42
F843-48

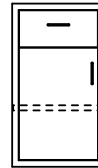

F844-15
F844-18
F844-21
F844-24



F845-15
F845-18
F845-21
F845-24

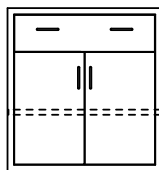

F846-30
F846-36
F846-42
F846-48

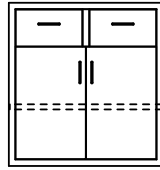

F847-30
F847-36
F847-42
F847-48

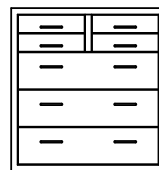

F848-30
F848-36
F848-42
F848-48

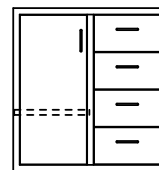

F849-30
F849-36
F849-42
F849-48

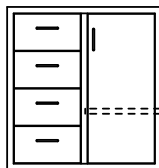

F850-30
F850-36
F850-42
F850-48

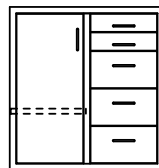

F851-30
F851-36
F851-42
F851-48

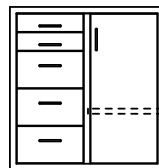

F852-30
F852-36
F852-42
F852-48

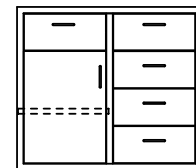

F853-30
F853-36
F853-42
F853-48

SUSPENDED CABINETS

31 3/4" HIGH x 22" DEEP

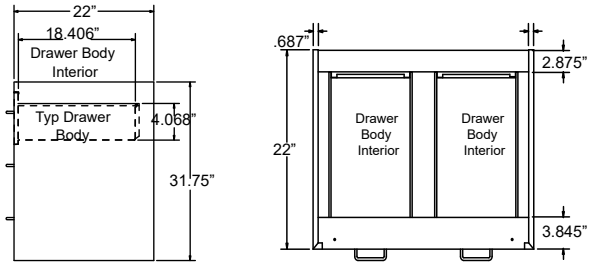

Drawer & Door Heights			
Drawer Letter	Approx. Height	Door Letter	Approx. Height
A	3-1/2"	E	14-1/2"
B	7"	G	22"
C	10-1/2"	H	29"
D	14-1/2"		

Review the beginning of this section to properly indicate your cabinet selections.

Cabinets come standard with wire pull.

Please note: You must specify lock keying preferences when ordering locks; master keying and grand master keying may incur additional costs.

Note : Add "-S" at the end of model number for Stainless Steel Casework. Example F856-48-S

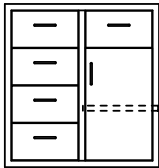

- F854-30
- F854-36
- F854-42
- F854-48

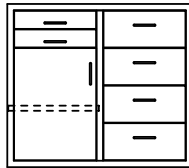

- F855-30
- F855-36
- F855-42
- F855-48



- F856-30
- F856-36
- F856-42
- F856-48

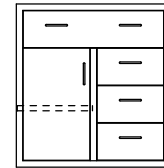

- F857-30
- F857-36
- F857-42
- F857-48

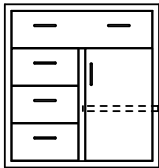

- F858-30
- F858-36
- F858-42
- F858-48



- F859-15
- F859-18
- F859-21
- F859-24

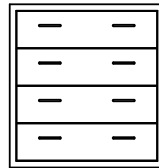

- F860-30
- F860-36
- F860-42
- F860-48

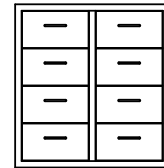

- F861-30
- F861-36
- F861-42
- F861-48



- F862-15
- F862-18
- F862-21
- F862-24

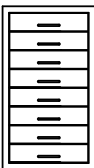

- F863-15
- F863-18
- F863-21
- F863-24



- F864-15
- F864-18
- F864-21
- F864-24

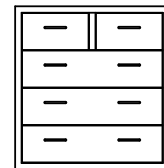

- F865-30
- F865-36
- F865-42
- F865-48

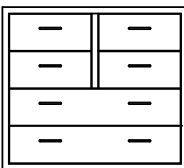

- F866-30
- F866-36
- F866-42
- F866-48

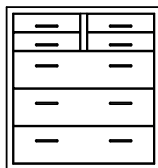

- F867-30
- F867-36
- F867-42
- F867-48

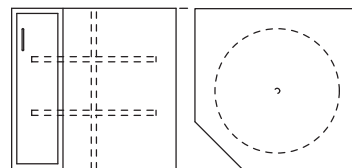

F868-32 – Suspended Corner Cabinet Right Hand Only



SAI SYSTEMS

Scientifically Advanced Interiors

Toll Free: (866) 527-2970

sales@saisns.com

www.saisns.com

BURNABY

TORONTO

HALIFAX