



## WALL CABINET INSTALLATIONS

Painted Steel & Stainless Steel



# WALL CABINETS

18" HIGH

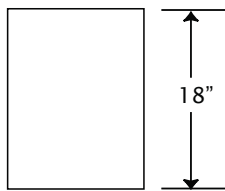

Section View

### Cabinet Features

Please specify type of handles required prior to order, i.e. wired pull or recessed pull  
 Locks to be ordered separately.  
 Master keying and grand master keying will incur additional costs.  
 Frameless glass doors cabinets; 1/4" Tempered Glass  
 Framed glass doors cabinets; 1/4" Float Glass  
 Available in 12", 13" and 16" depth.  
 For 16" deep wall cabinets, please add "16" after the model number.  
 Example: W251-3016

**Note : Add "-S" at the end of model number for Stainless Steel Casework. Example W231-L15-S**

Open Face Cabinet -18" High

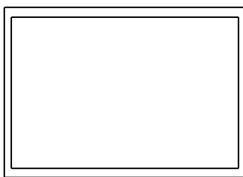

- W221-12    W221-30
- W221-15    W221-36
- W221-18    W221-42
- W221-24    W221-48

Solid Swing Door Cabinet - 18" High

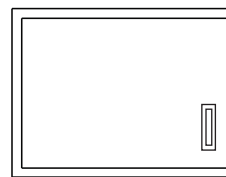

- W231-L12    W231-R12
- W231-L15    W231-R15
- W231-L18    W231-R18
- W231-L21    W231-R21
- W231-L24    W231-R24

\*L= Left Hinge R= Right Hinge

Solid Swing Door Cabinet - 18" High

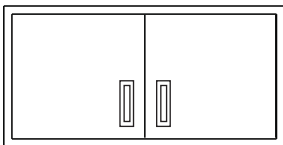

- W241-30
- W241-36
- W241-42
- W241-48

Solid Sliding Door Cabinet - 18" High

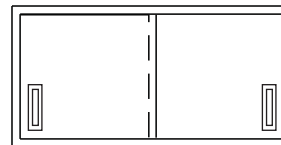

- W251-30
- W251-36
- W251-42
- W251-48

Glass Swing Door Cabinet - 18" High

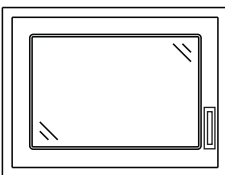

- W261-L12    W261-R12
- W261-L15    W261-R15
- W261-L18    W261-R18
- W261-L21    W261-R21
- W261-L24    W261-R24

\*L= Left Hinge R= Right Hinge

Framed Glass Sliding Door Cabinet - 18" High

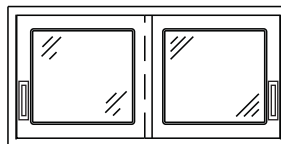

- W271-30
- W271-36
- W271-42
- W271-48

Glass Swing Door Cabinet - 18" High

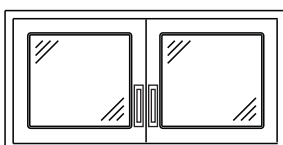

- W281-30
- W281-36
- W281-42
- W281-48

Frameless Glass Sliding Door Cabinet - 18" High

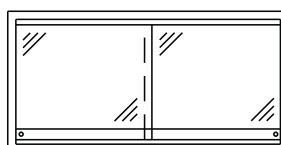

- W291-30
- W291-36
- W291-42
- W291-48

# WALL CABINETS

24" HIGH

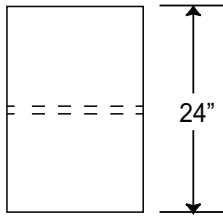

Section View

### Cabinet Features

Please specify type of handles required prior to order, i.e. wired pull or recessed pull  
 Locks to be ordered separately.  
 Master keying and grand master keying will incur additional costs.  
 Frameless glass doors cabinets; 1/4" Tempered Glass  
 Framed glass doors cabinets; 1/4" Float Glass  
 Available in 12", 13" and 16" depth.  
 For 16" deep wall cabinets, please add "16" after the model number.  
 Example: W252-3016

**Note : Add "-S" at the end of model number for Stainless Steel Casework. Example W231-L15-S**

Open Face Cabinet-24" High

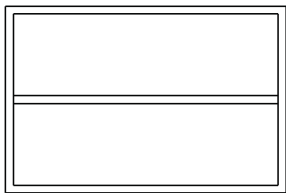

- W222-12      W222-30
- W222-15      W222-36
- W222-18      W222-42
- W222-24      W222-48

Solid Swing Door Cabinet - 24" High

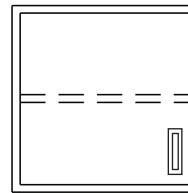

- W232-L12      W232-R12
- W232-L15      W232-R15
- W232-L18      W232-R18
- W232-L21      W232-R21
- W232-L24      W232-R24

\*L= Left Hinge R= Right Hinge

Solid Swing Door Cabinet-24" High

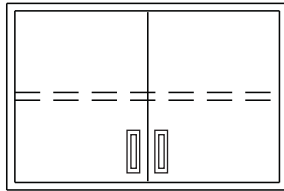

- W242-30
- W242-36
- W242-42
- W242-48

Solid Sliding Door Cabinet-24" High

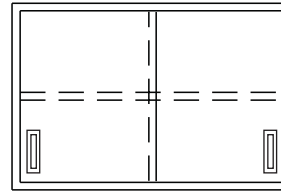

- W252-30
- W252-36
- W252-42
- W252-48

Glass Swing Door Cabinet -24" High

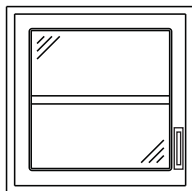

- W262-L12      W262-R12
- W262-L15      W262-R15
- W262-L18      W262-R18
- W262-L21      W262-R21
- W262-L24      W262-R24

\*L= Left Hinge R= Right Hinge

Glass Sliding Door Cabinet-24" High

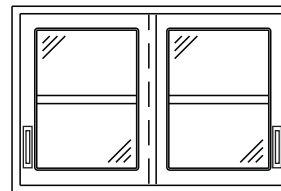

- W272-30
- W272-36
- W272-42
- W272-48

Framed Glass Swing Door Cabinet-24" High

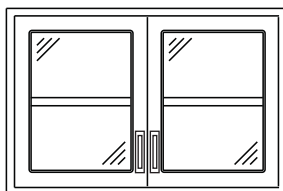

- W282-30
- W282-36
- W282-42
- W282-48

Frameless Glass Sliding Door Cabinet-24" High

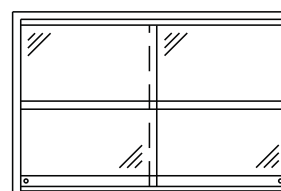

- W292-30
- W292-36
- W292-42
- W292-48

# WALL CABINETS

30" HIGH

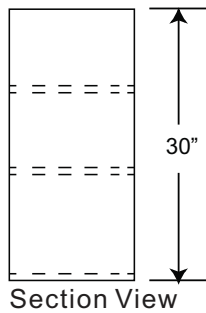

### Cabinet Features

Please specify type of handles required prior to order, i.e. wired pull or recessed pull  
 Locks to be ordered separately.  
 Master keying and grand master keying will incur additional costs.  
 Frameless glass doors cabinets; 1/4" Tempered Glass  
 Framed glass doors cabinets; 1/4" Float Glass  
 Available in 12", 13" and 16" depth.  
 For 16" deep wall cabinets, please add "16" after the model number.  
 Example: W243-3016

**Note : Add "-S" at the end of model number for Stainless Steel Casework. Example W231-L15-S**

Open Face Cabinet – 30" High



- W223-12    W223-30
- W223-15    W223-36
- W223-18    W223-42
- W223-24    W223-48

Solid Swing Door Cabinet - 30" High

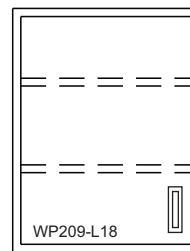

- W233-L12    W233-R12
- W233-L15    W233-R15
- W233-L18    W233-R18
- W233-L21    W233-R21
- W233-L24    W233-R24

\*L= Left Hinge    R= Right Hinge

Solid Swing Door Cabinet – 30" High

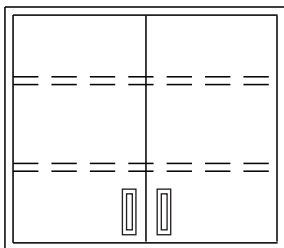

- W243-30
- W243-36
- W243-42
- W243-48

Solid Sliding Door Cabinet – 30" High

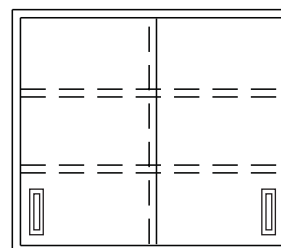

- W253-30
- W253-36
- W253-42
- W253-48

Glass Swing Door Cabinet– 30" High

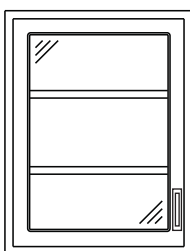

- W263-L12    W263-R12
- W263-L15    W263-R15
- W263-L18    W263-R18
- W263-L21    W263-R21
- W263-L24    W263-R24

\*L= Left Hinge    R= Right Hinge

Glass Sliding Door Cabinet – 30" High

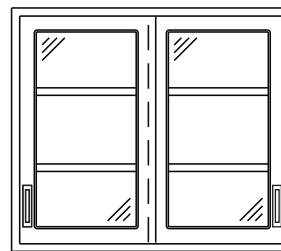

- W273-30
- W273-36
- W273-42
- W273-48

Framed Glass Swing Door Cabinet – 30" High

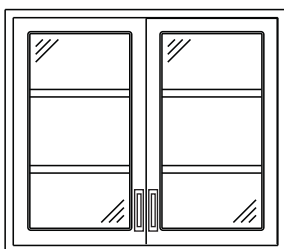

- W283-30
- W283-36
- W283-42
- W283-48

Frameless Glass Sliding Door Cabinet – 30" High

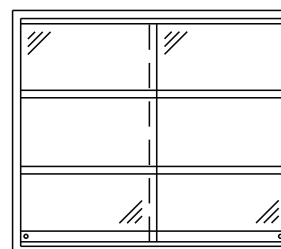

- W293-30
- W293-36
- W293-42
- W293-48

# WALL CABINETS

## 36" HIGH

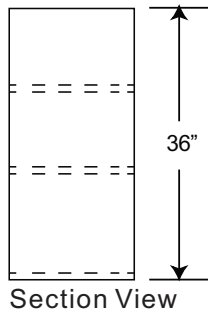

### Cabinet Features

Please specify type of handles required prior to order, i.e. wired pull or recessed pull  
 Locks to be ordered separately.  
 Master keying and grand master keying will incur additional costs.  
 Frameless glass doors cabinets; 1/4" Tempered Glass  
 Framed glass doors cabinets; 1/4" Float Glass  
 Available in 12", 13" and 16" depth.  
 For 16" deep wall cabinets, please add "16" after the model number.  
 Example: W294-3016

**Note : Add "-S" at the end of model number for Stainless Steel Casework. Example W231-L15-S**

Open Face Cabinet – 36" High

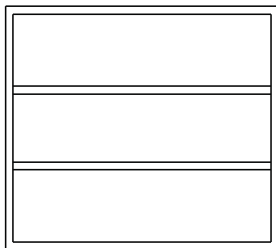

- W224-12      W224-30
- W224-15      W224-36
- W224-18      W224-42
- W224-24      W224-48

Solid Swing Door Cabinet - 36" High

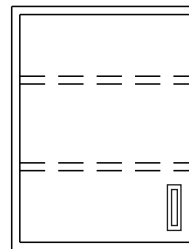

- W234-L12      W234-R12
- W234-L15      W234-R15
- W234-L18      W234-R18
- W234-L21      W234-R21
- W234-L24      W234-R24

\*L= Left Hinge R= Right Hinge

Solid Swing Door Cabinet – 36" High

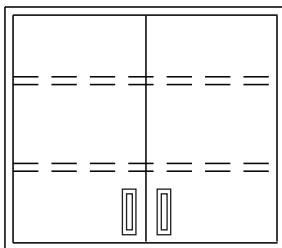

- W244-30
- W244-36
- W244-42
- W244-48

Solid Sliding Door Cabinet – 36" High

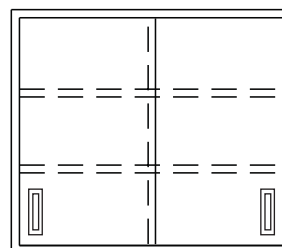

- W254-30
- W254-36
- W254-42
- W254-48

Glass Swing Door Cabinet– 36" High

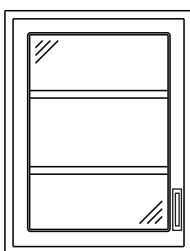

- W264-L12      W264-R12
- W26-L15      W264-R15
- W264-L18      W264-R18
- W264-L21      W264-R21
- W264-L24      W264-R24

\*L= Left Hinge R= Right Hinge

Glass Sliding Door Cabinet – 36" High

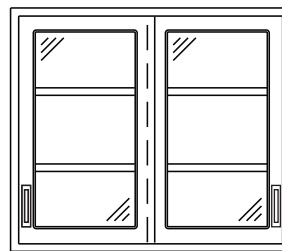

- W274-30
- W274-36
- W274-42
- W274-48

Framed Glass Swing Door Cabinet – 36" High

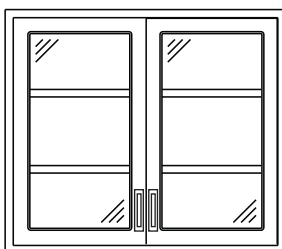

- W284-30
- W284-36
- W284-42
- W284-48

Frameless Glass Sliding Door Cabinet – 36" High

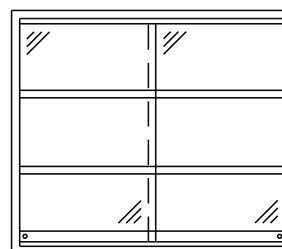

- W294-30
- W294-36
- W294-42
- W294-48

# WALL CABINETS

42" HIGH

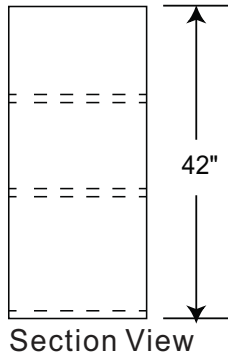

### Cabinet Features

Please specify type of handles required prior to order, i.e. wired pull or recessed pull  
 Locks to be ordered separately.  
 Master keying and grand master keying will incur additional costs.  
 Frameless glass doors cabinets; 1/4" Tempered Glass  
 Framed glass doors cabinets; 1/4" Float Glass  
 Available in 12", 13" and 16" depth.  
 For 16" deep wall cabinets, please add "16" after the model number.  
 Example: W255-3016

**Note :** Add "-S" at the end of model number for Stainless Steel Casework. Example W231-L15-S

Open Face Cabinet – 42" High

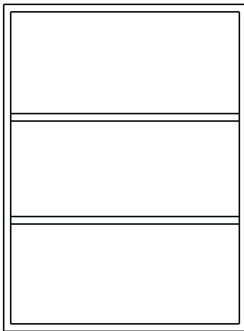

- |         |         |
|---------|---------|
| W225-12 | W225-30 |
| W225-15 | W225-36 |
| W225-18 | W225-42 |
| W225-24 | W225-48 |

Solid Swing Door Cabinet - 42" High

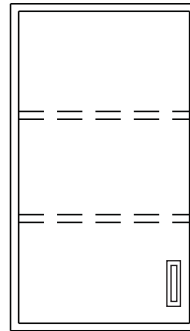

- |          |          |
|----------|----------|
| W235-L12 | W235-R12 |
| W235-L15 | W235-R15 |
| W235-L18 | W235-R18 |
| W235-L21 | W235-R21 |
| W235-L24 | W235-R24 |

\*L= Left Hinge R= Right Hinge

Solid Swing Door Cabinet – 42" High

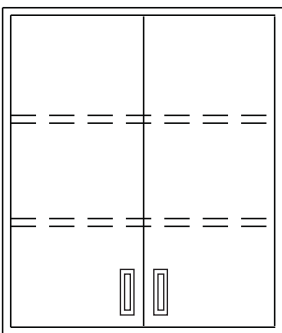

- |         |
|---------|
| W245-30 |
| W245-36 |
| W245-42 |
| W245-48 |

Solid Sliding Door Cabinet – 42" High

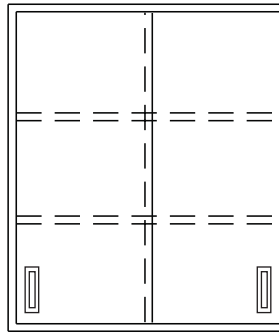

- |         |
|---------|
| W255-30 |
| W255-36 |
| W255-42 |
| W255-48 |

# WALL CABINETS

# 42" HIGH

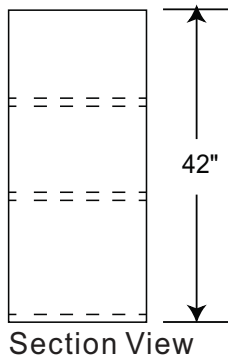

### Cabinet Features

Please specify type of handles required prior to order, i.e. wired pull or recessed pull  
 Locks to be ordered separately.  
 Master keying and grand master keying will incur additional costs.  
 Frameless glass doors cabinets; 1/4" Tempered Glass  
 Framed glass doors cabinets; 1/4" Float Glass  
 Available in 12", 13" and 16" depth.  
 For 16" deep wall cabinets, please add "16" after the model number.  
 Example: W275-3016

**Note : Add "-S" at the end of model number for Stainless Steel Casework. Example W231-L15-S**

Open Face Cabinet – 42" High

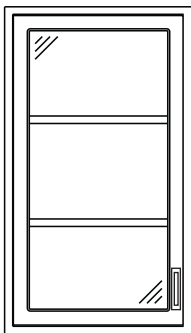

- W265-L12    W265-R12
- W265-L15    W265-R15
- W265-L18    W265-R18
- W265-L21    W265-R21
- W265-L24    W265-R24

\*L= Left Hinge    R= Right Hinge

Solid Sliding Door Cabinet - 42" High

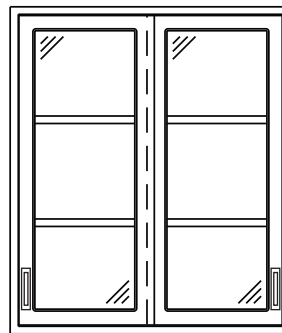

- W275-30
- W275-36
- W275-42
- W275-48

Solid Swing Door Cabinet – 42" High

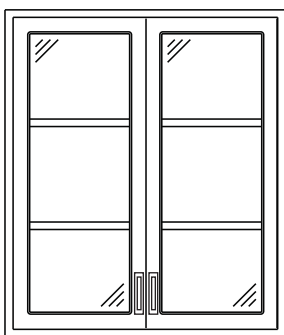

- W285-30
- W285-36
- W285-42
- W285-48

Solid Sliding Door Cabinet – 42" High

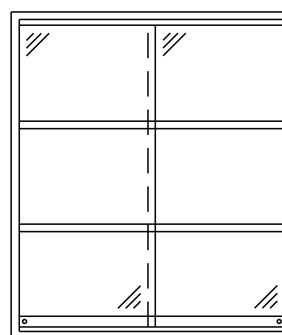

- W295-30
- W295-36
- W295-42
- W295-48

# WALL CABINETS

48" HIGH

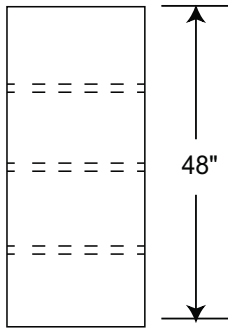

Section View

### Cabinet Features

Please specify type of handles required prior to order, i.e. wired pull or recessed pull  
 Locks to be ordered separately.  
 Master keying and grand master keying will incur additional costs.  
 Frameless glass doors cabinets; 1/4" Tempered Glass  
 Framed glass doors cabinets; 1/4" Float Glass  
 Available in 12", 13" and 16" depth.  
 For 16" deep wall cabinets, please add "16" after the model number.  
 Example: W256-3016

**Note :** Add "-S" at the end of model number for **Stainless Steel Casework.** Example **W231-L15-S**

Open Face Cabinet – 48" High

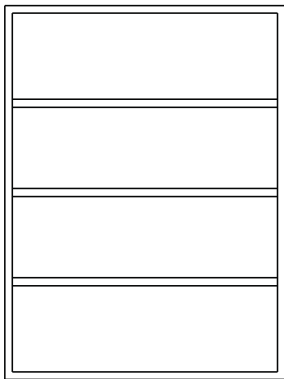

- |         |         |
|---------|---------|
| W226-12 | W226-30 |
| W226-15 | W226-36 |
| W226-18 | W226-42 |
| W226-24 | W226-48 |

Solid Swing Door Cabinet - 48" High

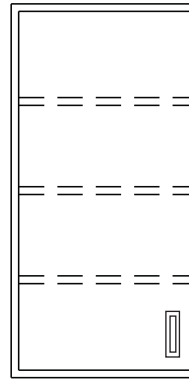

- |          |          |
|----------|----------|
| W236-L12 | W236-R12 |
| W236-L15 | W236-R15 |
| W236-L18 | W236-R18 |
| W236-L21 | W236-R21 |
| W236-L24 | W236-R24 |

\*L= Left Hinge R= Right Hinge

Solid Swing Door Cabinet – 48" High

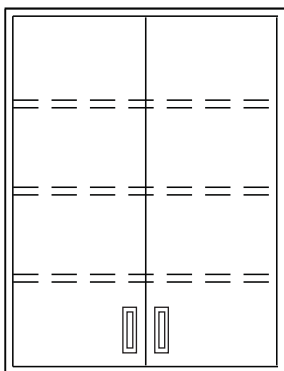

- |         |
|---------|
| W246-30 |
| W246-36 |
| W246-42 |
| W246-48 |

Solid Sliding Door Cabinet – 48" High

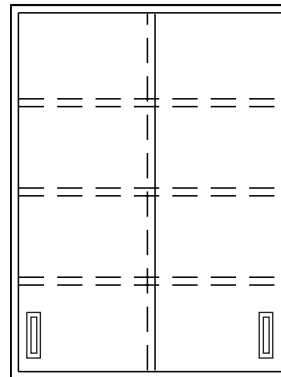

- |         |
|---------|
| W256-30 |
| W256-36 |
| W256-42 |
| W256-48 |



# WALL CABINETS

48" HIGH

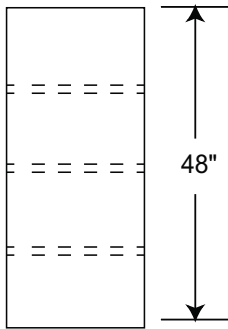

Section View

**Cabinet Features**

Please specify type of handles required prior to order, i.e. wired pull or recessed pull  
 Locks to be ordered separately.  
 Master keying and grand master keying will incur additional costs.  
 Frameless glass doors cabinets; 1/4" Tempered Glass  
 Framed glass doors cabinets; 1/4" Float Glass  
 Available in 12", 13" and 16" depth.  
 For 16" deep wall cabinets, please add "16" after the model number.  
 Example: W276-3016

**Note : Add "-S" at the end of model number for Stainless Steel Casework. Example W231-L15-S**

Open Face Cabinet – 48" High

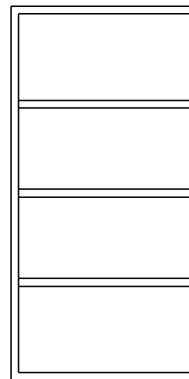

- W257-12
- W257-15
- W257-18
- W257-21
- W257-24

Open Face Cabinet – 48" High

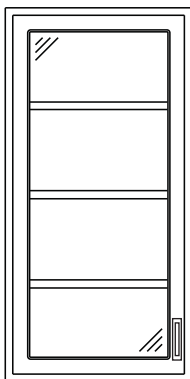

- W266-L12    W266-R12
- W266-L15    W266-R15
- W266-L18    W266-R18
- W266-L21    W266-R21
- W266-L24    W266-R24

\*L= Left Hinge    R= Right Hinge

Solid Sliding Door Cabinet - 48" High

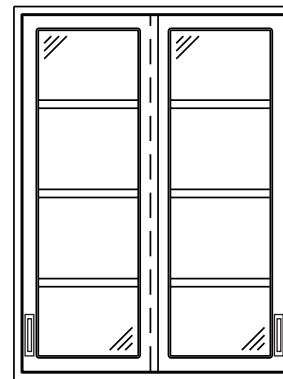

- W276-30
- W276-36
- W276-42
- W276-48

Solid Swing Door Cabinet – 48" High

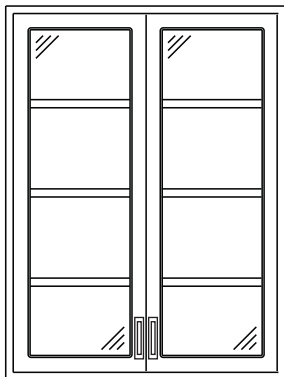

- W286-30
- W286-36
- W286-42
- W286-48

Solid Sliding Door Cabinet – 48" High

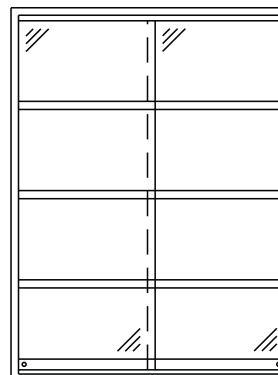

- W296-30
- W296-36
- W296-42
- W296-48

# WALL CORNER CABINETS

30" WIDE

Please specify type of handles required prior to order, i.e. wired or recessed pull.  
 Locks to be ordered separately.  
 Master keying and grand master keying will incur additional costs.  
 Frameless glass door cabinets, 1/4" Tempered Glass  
 Framed glass door cabinets, 1/4" Float Glass  
 Example: WC22-R3016  
 Available in 12", 13" and 16" depth.  
 For 16" deep wall cabinets, please add "16" after the model number.

**Note : Add "-S" at the end of model number for Stainless Steel Casework. Example W231-L15-S**

### Dead-Corner - Solid Door

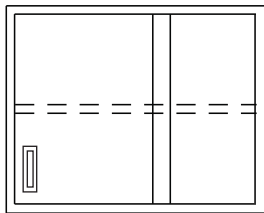

- WC22-R30 (24" high)
- WC22-R30 (30" high)
- WC22-R30 (36" high)
- WC22-R30 (42" high)
- WC22-R30 (48" high)

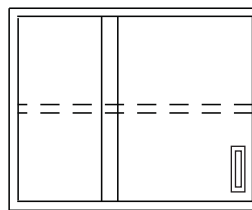

- WC33-L30 (24" high)
- WC33-L30 (30" high)
- WC33-L30 (36" high)
- WC33-L30 (42" high)
- WC33-L30 (48" high)

### Dead-Corner - Glass Door

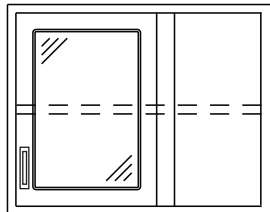

- WC44-R30 (24" high)
- WC44-R30 (30" high)
- WC44-R30 (36" high)
- WC44-R30 (42" high)
- WC44-R30 (48" high)

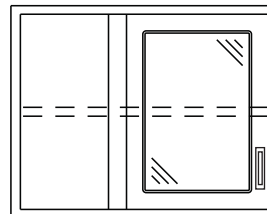

- WC55-L30 (24" high)
- WC55-L30 (30" high)
- WC55-L30 (36" high)
- WC55-L30 (42" high)
- WC55-L30 (48" high)

### Corner Angled Cabinets

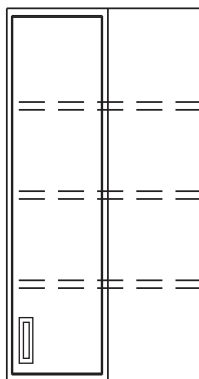

- WA66-L30 WA66-R30 (24" high)
- WA66-L30 WA66-R30 (30" high)
- WA66-L30 WA66-R30 (36" high)
- WA66-L30 WA66-R30 (42" high)
- WA66-L30 WA66-R30 (48" high)

\*L= Left Hinge R= Right Hinge

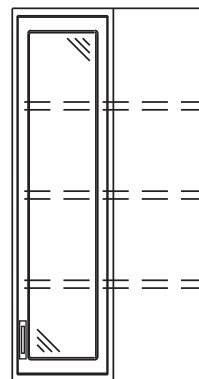

- WA77-L30 WA77-R30 (24" high)
- WA77-L30 WA77-R30 (30" high)
- WA77-L30 WA77-R30 (36" high)
- WA77-L30 WA77-R30 (42" high)
- WA77-L30 WA77-R30 (48" high)

\*L= Left Hinge R= Right Hinge



## **SAI SYSTEMS**

*Scientifically Advanced Interiors*

Toll Free: (866) 527-2970

[sales@saisns.com](mailto:sales@saisns.com)

[www.saisns.com](http://www.saisns.com)

BURNABY

TORONTO

HALIFAX